

CAST STAINLESS STEEL LIFT-CHECK VALVE - ANSI CLASS 150

DESIGN DESCRIPTION:

- BOLTED COVER
- LIFT TYPE
- FOR HORIZONTAL LINE
- INTEGRAL SEAT
- FLANGED ENDS

APPLICABLE STANDARDS:

- STEEL VALVES, ANSI B16.34
- FACE TO FACE, ANSI B16.10
- END FLANGES, ANSI B16.5
- INSPECTION AND TEST, API 598

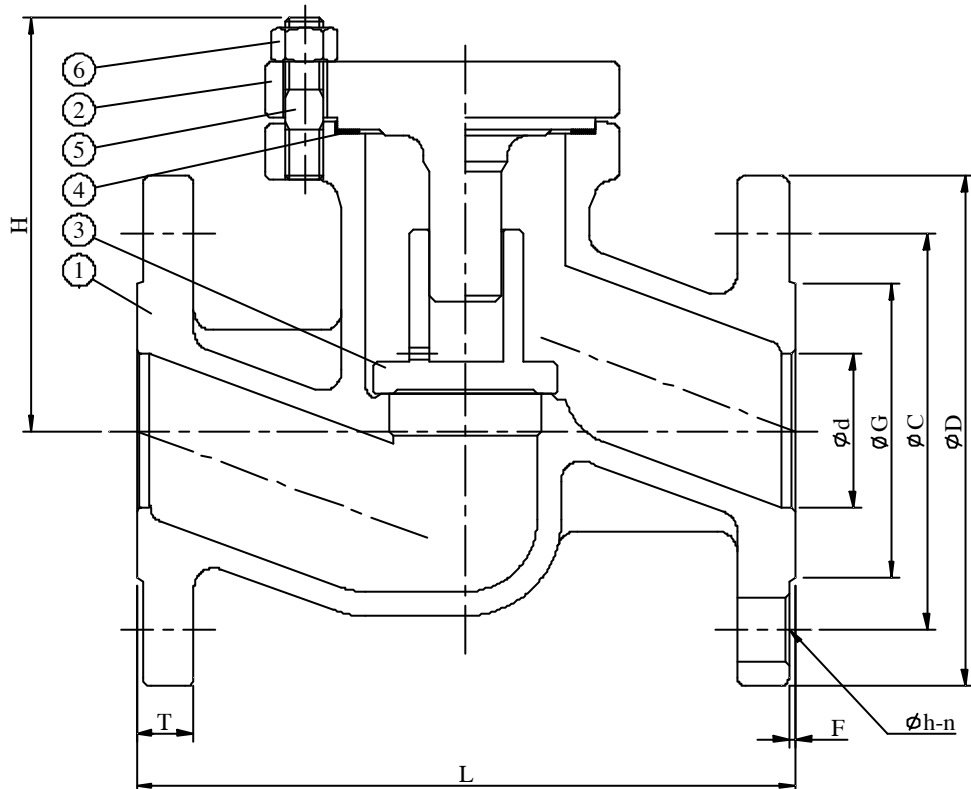

PARTS AND MATERIAL (ASTM)

NO.	PARTS NAME	MATERIALS		
		CF8	CF8M	CF3M
1	Body	A351-CF8	A351-CF8M	A351-CF3M
2	Cover	A351-CF8	A351-CF8M	A351-CF3M
3	Disc	A276-304	A276-316	A276-316L
4	Gasket	V#1500AC / RTFE		
5	Cover Bolt	A193-B8		
6	Cover Bolt Nut	A194-8		
7	Name Plate	A666-304		

TEST PRESSURE TO API 598

PSIG

SHELL TEST (water)	SEAT TEST (water)	SEAT TEST (air)
450 (32 kg/cm ²)	314 (22 kg/cm ²)	80 (6 kg/cm ²)

OTHER MATERIALS ARE AVAILABLE UPON REQUEST.

DIMENSION TABLE:

DN	NPS	ød	L	H	T	F	Ø	øC	øG	øh	n	WT.(Kg)
15	1/2	15.0	108.0	71.0	10.0	1.6	88.9	60.5	35.1	16.0	4	3.5
20	3/4	19.1	117.3	74.0	10.0	1.6	98.6	69.9	42.9	16.0	4	4.0
25	1	25.4	127.0	77.5	11.1	1.6	108.0	79.3	50.8	16.0	4	6.0
40	1 1/2	38.1	165.1	103.0	14.2	1.6	127.0	98.6	73.2	16.0	4	7.0