

FORGED STEEL CHECK VALVES - ANSI CLASS 150~800

DESIGN DESCRIPTION:

- BOLTED COVER
- LIFT TYPE

APPLICABLE STANDARDS:

- DESIGN PER API 602
- SOCKET WELD AND THREADED END PER ANSI B16.11
- PIPE THREADS PER ANSI B1.20.1
- FLANGED END PER ANSI B16.5
- INSPECTON AND TEST PER API 598

SOCKET WELD ENDS
SCREWED ENDS
FLANGED ENDS

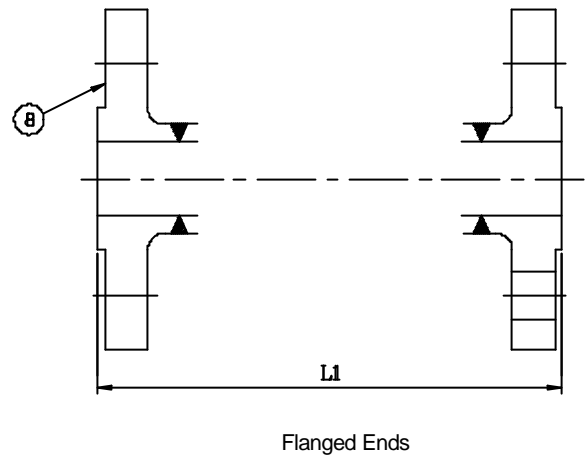
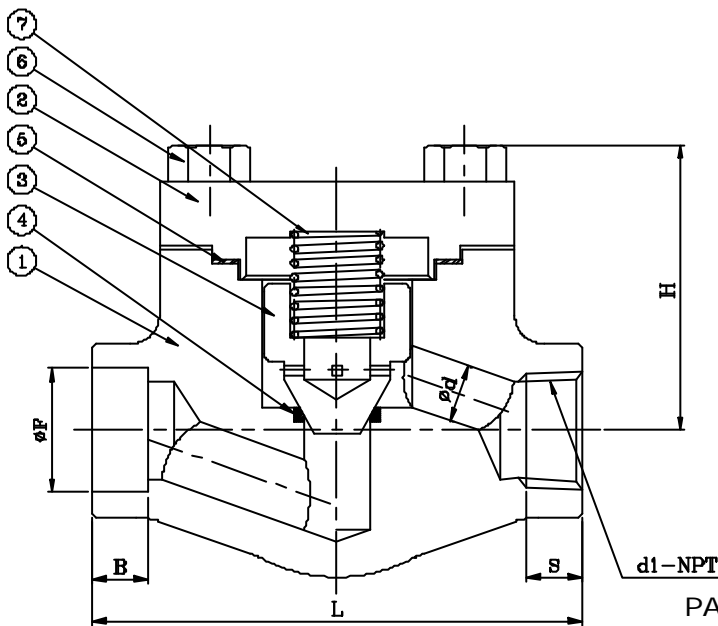

PARTS AND MATERIAL (ASTM)

NO.	PARTS NAME	MATERIALS
1	Body	A105
2	Cover	A105
3	Disc	A276-410
4	Seat	A276-410+H/F STL#6
5	Gasket	Grafoil + 304 Spiralwound
6	Cover Bolt	A193-B7
7	Spring	SUS 304
8	Flange	A105

TEST PRESSURE TO API 598

CLASS	SHELL TEST (water)	SEAT TEST (water)	PSIC
			SEAT TEST (air)
150	450 (32 kg/cm ²)	314 (22 kg/cm ²)	80 (6 kg/cm ²)
300	1125 (79 kg/cm ²)	814 (57 kg/cm ²)	80 (6 kg/cm ²)
600	2225 (156 kg/cm ²)	1628 (114 kg/cm ²)	80 (6 kg/cm ²)
800	3000 (210 kg/cm ²)	2200 (154 kg/cm ²)	80 (6 kg/cm ²)

OTHER MATERIALS ARE AVAILABLE UPON REQUEST.

DIMENSION TABLE:

DN	NPS	Ø d	L	L1			H	SOCKET WELD		SCREWED		WT.(Kg) SW / NPT
				150#	300#	600#		ØF	B	d1	S	
15	1/2	10	79	108	152	165	48	22	10	1/2" NPT	13.5	1.3
20	3/4	14	92	118	178	191	48	27	13	3/4" NPT	14.0	1.6
25	1	18	111	127	203	216	63	34	13	1" NPT	17.5	2.9
40	1 1/2	28	152	165	229	241	85	49	13	1 1/2"	18.5	6
50	2	34	172	203	267	292	104	61	16	2" NPT	19.0	9.7